



CANBUILT MFG.

Toll-Free in Canada: 1-888-607-2926 Phone: 416-749-6555 Fax: 416-749-7597
Email: sales@canbuilt.com Website: www.canbuilt.com

103 Milvan Drive,
Toronto, Ontario,
Canada, M9L 1Z7

FLOOR MODEL DRILL PRESS

17" DRILL PRESS FLOOR MODEL

Model # **DPF-18FC**

NEW IMPROVED SWITCH SYSTEM

Line interruption electro-mechanical switch

- Built-in work light with front mounted on-off switch
- Spindle is supported by high quality bearings
- Cast iron pullys reduce vibration
- 45 degree tilting table for angular drilling
- 5/8" drill chuck and key included
- 16 speeds (240 - 3400 RPM)
- Locking depth stop for accurate repetitive blind hole drilling

- 5/8" Chuck Capacity
- 17" swing
- 23 3/4" Maximum chuck to table
- 44" chuck to base
- Table size: 13 3/4" dia.
- MT. #2 spindle Taper
- 1 HP 12 AMP
- 200 lbs shipping weight

OPTIONALLY AVAILABLE:

DPV-4000 - 4" Drill Press Vise

DPV-5000 - 5" Drill Press Vise

DPV-6000 - 6" Drill Press Vise

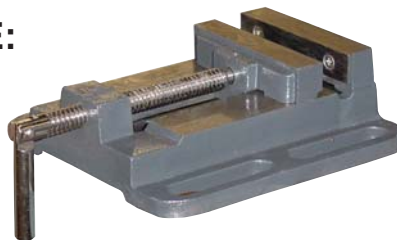

Model # **DPF-18FC**

QUALITY • PERFORMANCE • LONGEVITY